

FM - 400 U/H
FM - 500 /H

Spare Parts
Pièces Détachées
Ersatzteile
Onderdelen

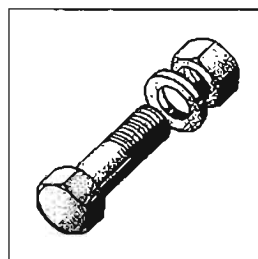

Content

Tank	FM-400 H / FM-500 H	4
Hood	FM-400 H / FM-500 H	5
Tank and panels	FM-400 U / FM-500	6
Door	FM-400 U / FM-500	7
Water Inlet		8
Anti-siphon-device	FM-400 H / FM-500 H	9
	FM-400 U / FM-500	10
Booster		11
Wash pump		12
Wash and rinse system		13
Drain and strainers		14
Drain pump	FM-400 U / FM-500	15
Control box		16
Transformer		17
Rinse booster pump	FM-400 H / FM-500 H	18
	FM-400 U / FM-500	19
Detergent dispenser	FM-400 H / FM-500 H	20
	FM-400 U / FM-500	21
Rinse agent dispenser		22
380/415/440 V	FM-400 H / FM-500 H	23
380/415/440 V	FM-400 U / FM-500	24
Extension	FM-400 U	26
Supporting frame	FM-400 UP / FM-500 P	27

Sommaire

Bac	FM-400 H / FM-500 H	4
Capot	FM-400 H / FM-500 H	5
Bac et panneaux	FM-400 U / FM-500	6
Porte	FM-400 U / FM-500	7
Arrivée d'eau		8
Brise-vide	FM-400 H / FM-500 H	9
	FM-400 U / FM-500	10
Chaudière		11
Pompe de lavage		12
Système de lavage et de rinçage		13
Vidange et filtres		14
Pompe de vidange	FM-400 U / FM-500	15
Coffret électrique		16
Transformateur		17
Pompe élévatrice de pression	FM-400 H / FM-500 H	18
	FM-400 U / FM-500	19
Doseur de produit détergent	FM-400 H / FM-500 H	20
	FM-400 U / FM-500	21
Doseur de produit lessiviel		22
380/415/440 V	FM-400 H / FM-500 H	23
380/415/440 V	FM-400 U / FM-500	24
Socle	FM-400 U	26
Bâti inférieur	FM-400 UP / FM-500 P	27

Inhalt

Tank	FM-400 H / FM-500 H	4
Haube	FM-400 H / FM-500 H	5
Tank und Verkleidung	FM-400 U / FM-500	6
Tür	FM-400 U / FM-500	7
Eingangsleitung		8
Rücksaugeverhinderer	FM-400 H / FM-500 H	9
	FM-400 U / FM-500	10
Boiler		11
Waschpumpe		12
Wasch- und Spülsystem		13
Ablauf und Siebe		14
Ablaufpumpe	FM-400 U / FM-500	15
Schaltkasten		16
Transformator		17
Drucksteigerungspumpe	FM-400 H / FM-500 H	18
	FM-400 U / FM-500	19
Waschmittel-Dosiergerät	FM-400 H / FM-500 H	20
	FM-400 U / FM-500	21
Klarspülmittel-Dosiergerät		22
380/415/440 V	FM-400 H / FM-500 H	23
380/415/440 V	FM-400 U / FM-500	24
Sockel	FM-400 U	26
Untergestell	FM-400 UP / FM-500 P	27

Inhoud

Tank	FM-400 H / FM-500 H	4
Kap	FM-400 H / FM-500 H	5
Tank en panelen	FM-400 U / FM-500	6
Deur	FM-400 U / FM-500	7
Water toevoer		8
Vacuumbreker	FM-400 H / FM-500 H	9
	FM-400 U / FM-500	10
Booster		11
Waspomp		12
Was en spoel-systeem		13
Afvoer en zeven		14
Afvoerpomp	FM-400 U / FM-500	15
Schakelkast		16
Transformator		17
Spoelpomp	FM-400 H / FM-500 H	18
	FM-400 U / FM-500	19
Afwasmiddel-doseerapparaat	FM-400 H / FM-500 H	20
	FM-400 U / FM-500	21
Spoelmiddel-doseerapparaat		22
380/415/440 V	FM-400 H / FM-500 H	23
380/415/440 V	FM-400 U / FM-500	24
Uitbreiding	FM-400 U	26
Onderstel	FM-400 UP / FM-500 P	27

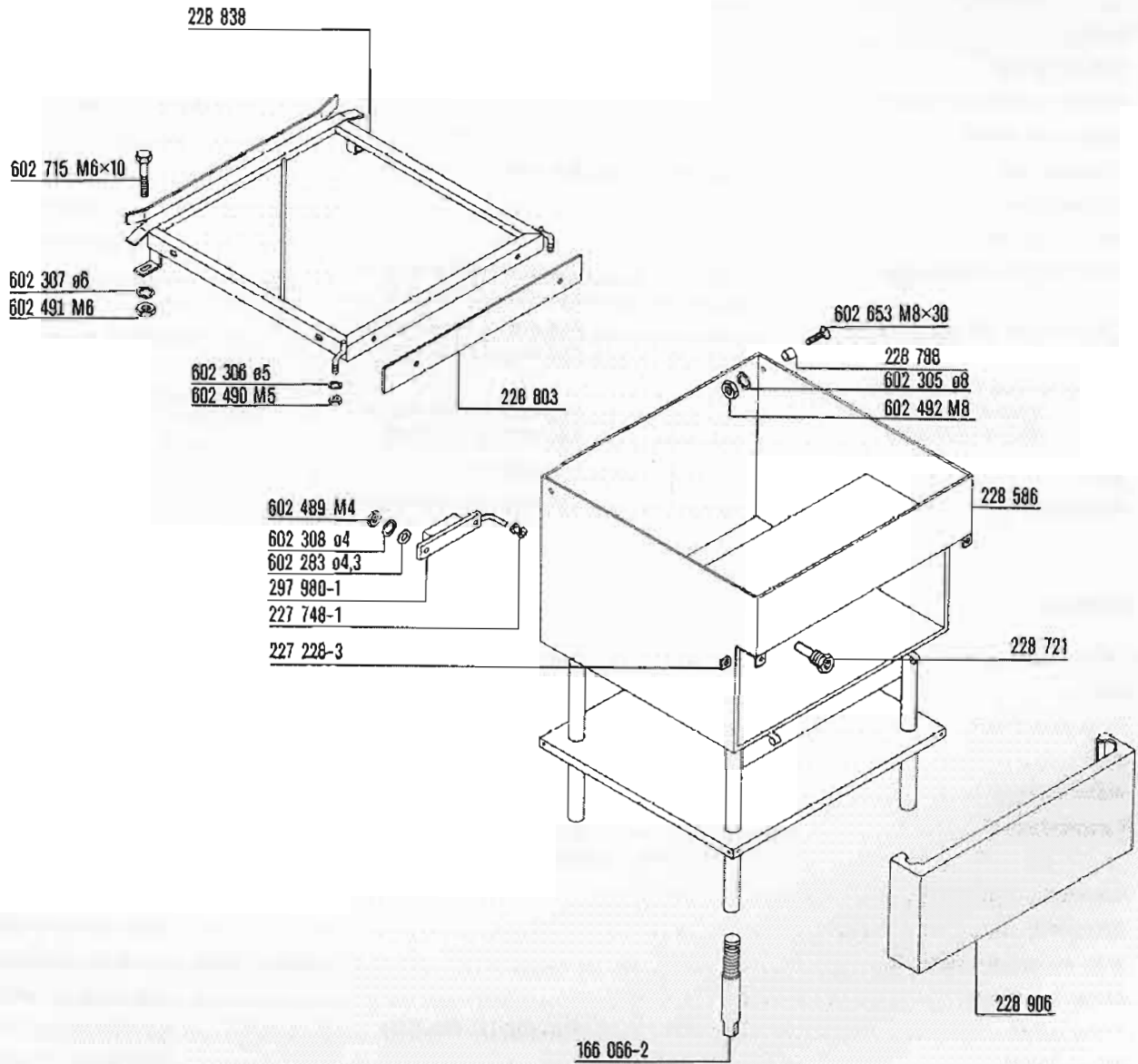

* without vacuum breaker
sans brise-vide
ohne Rücksaugeverhinderer
zonder vacuumbreker

** without detergent dispenser
sans doseur détergent
ohne Waschmittel-Dosiergerät
zonder wasmiddel-doseerapparaat

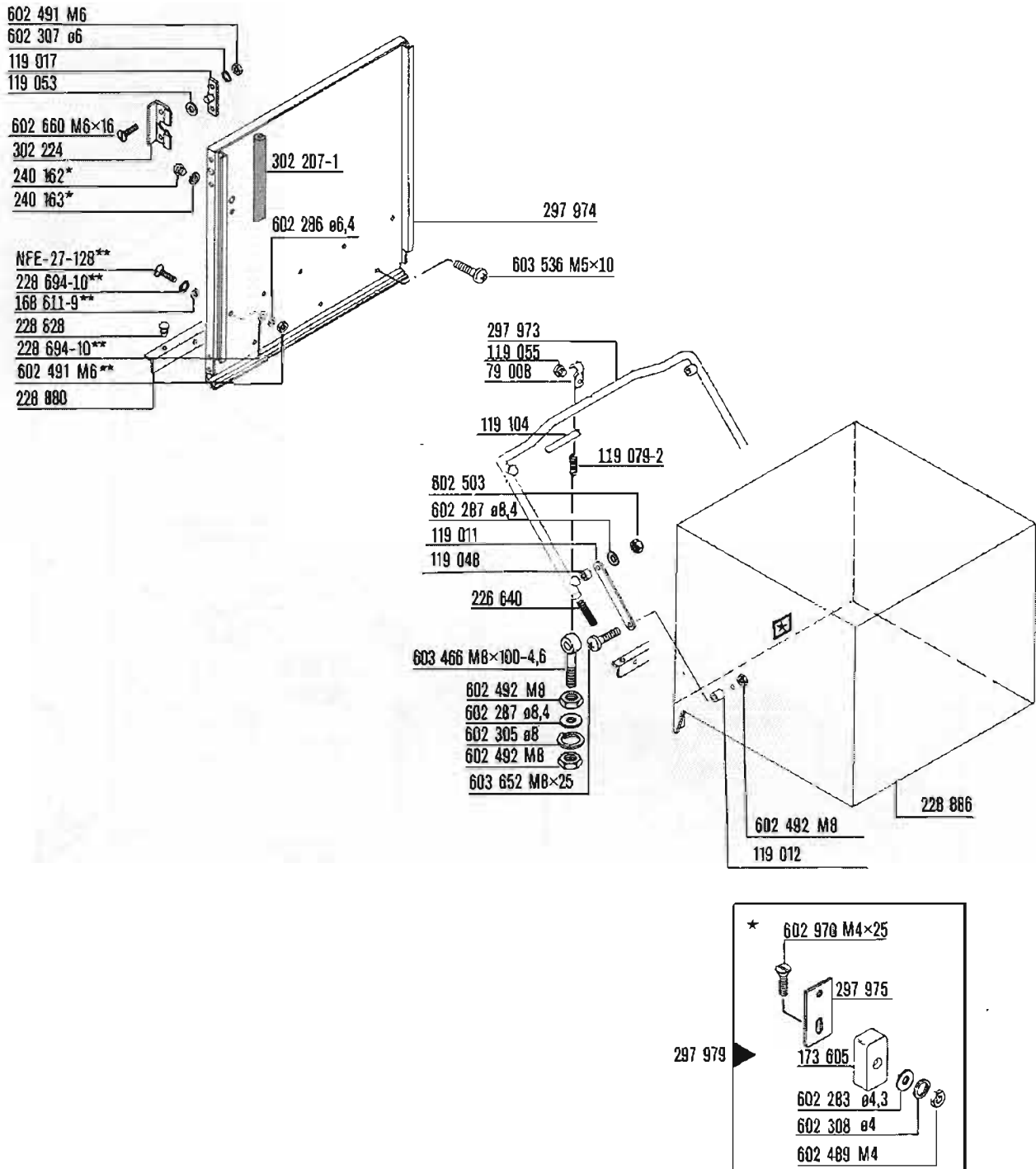

* without vacuum breaker
sans brise-vide
ohne Rücksaugeverhinderer
zonder vacuumbreker

** without detergent dispenser
sans doseur détergent
ohne Waschmittel-Dosiergerät
zonder wasmiddel-doseerapparaat

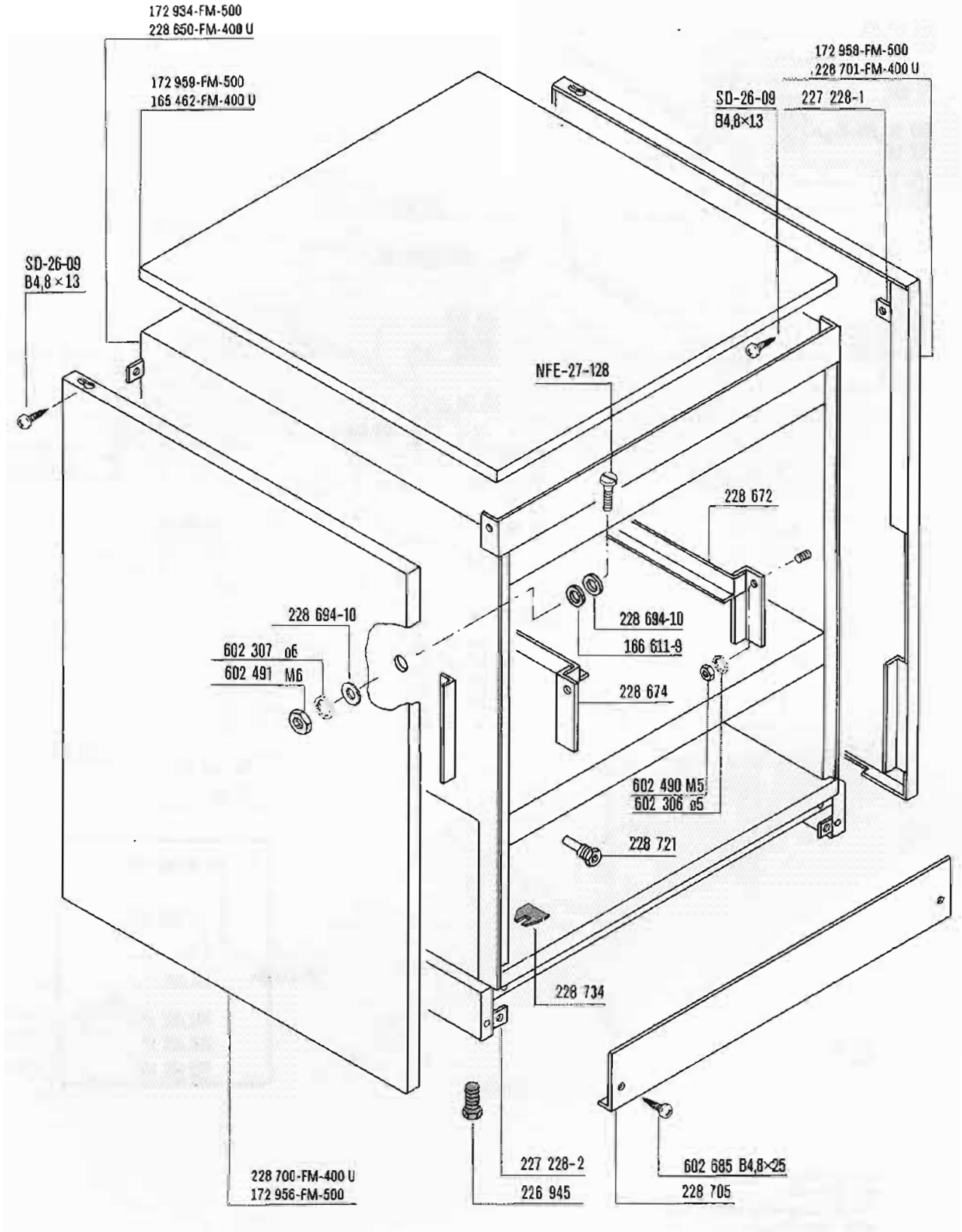

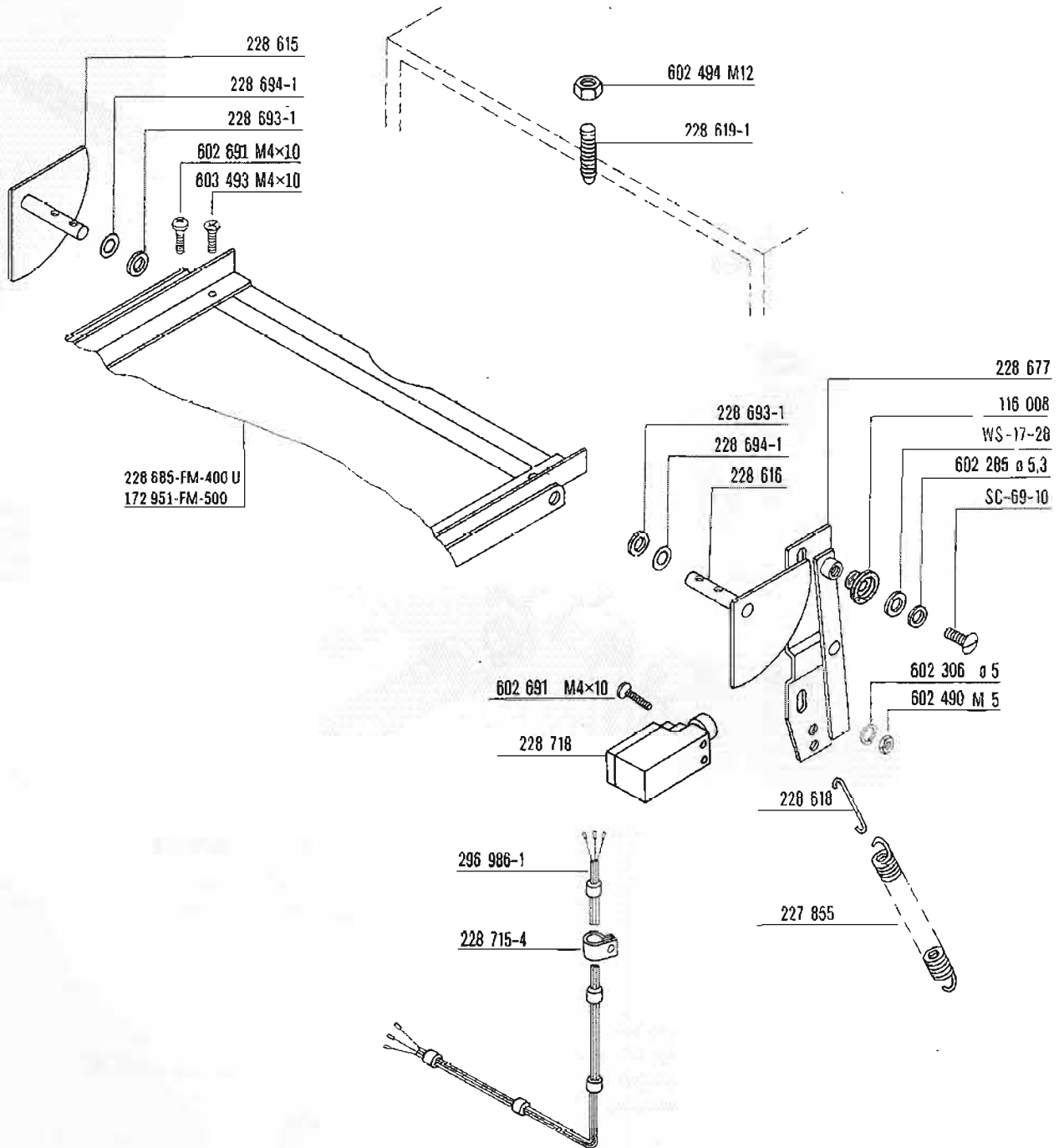

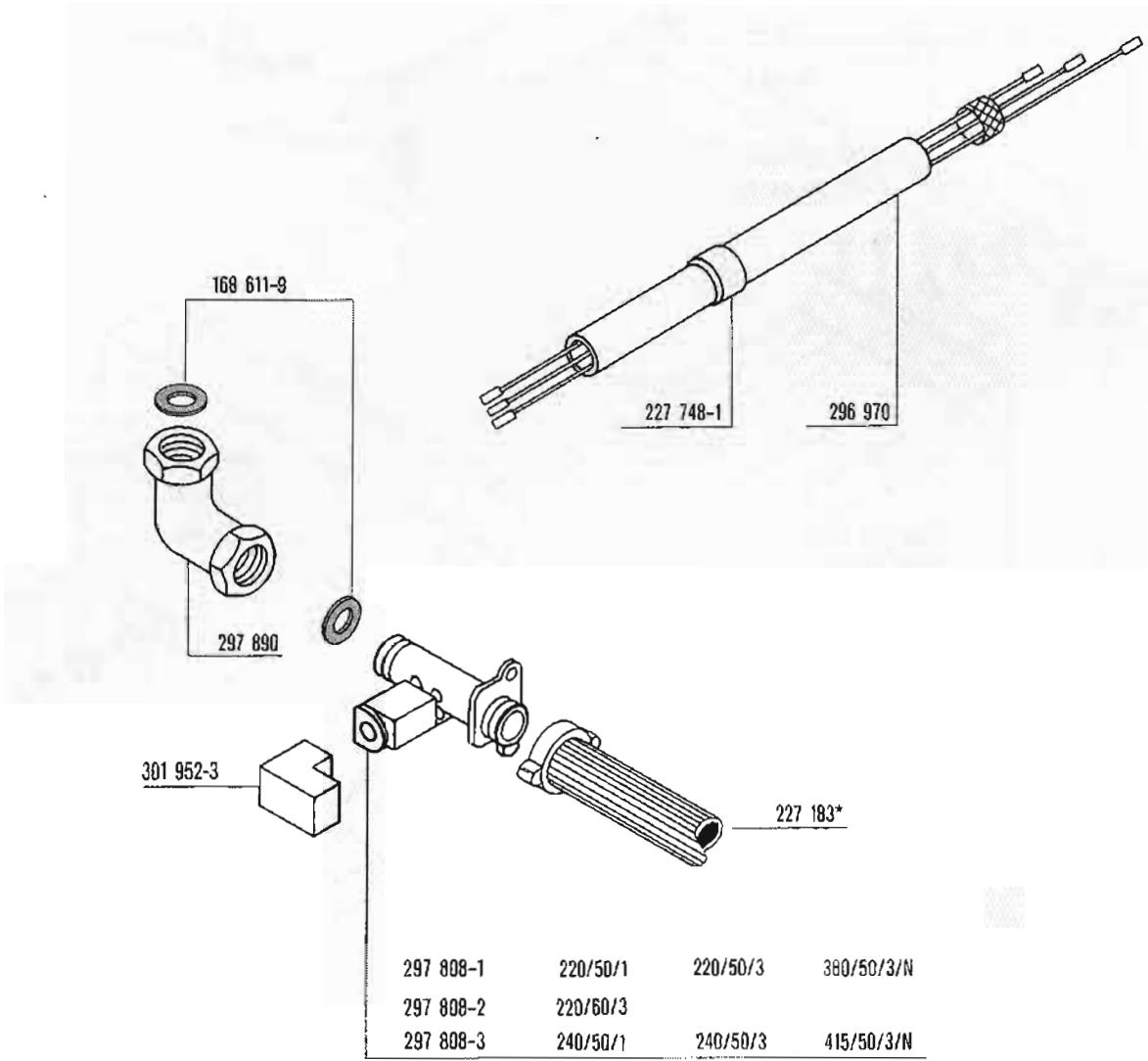

*with drain pump only
 slt. avec pompe de vidange
 nur bei Ablaufpumpe
 alleen met afvoerpomp

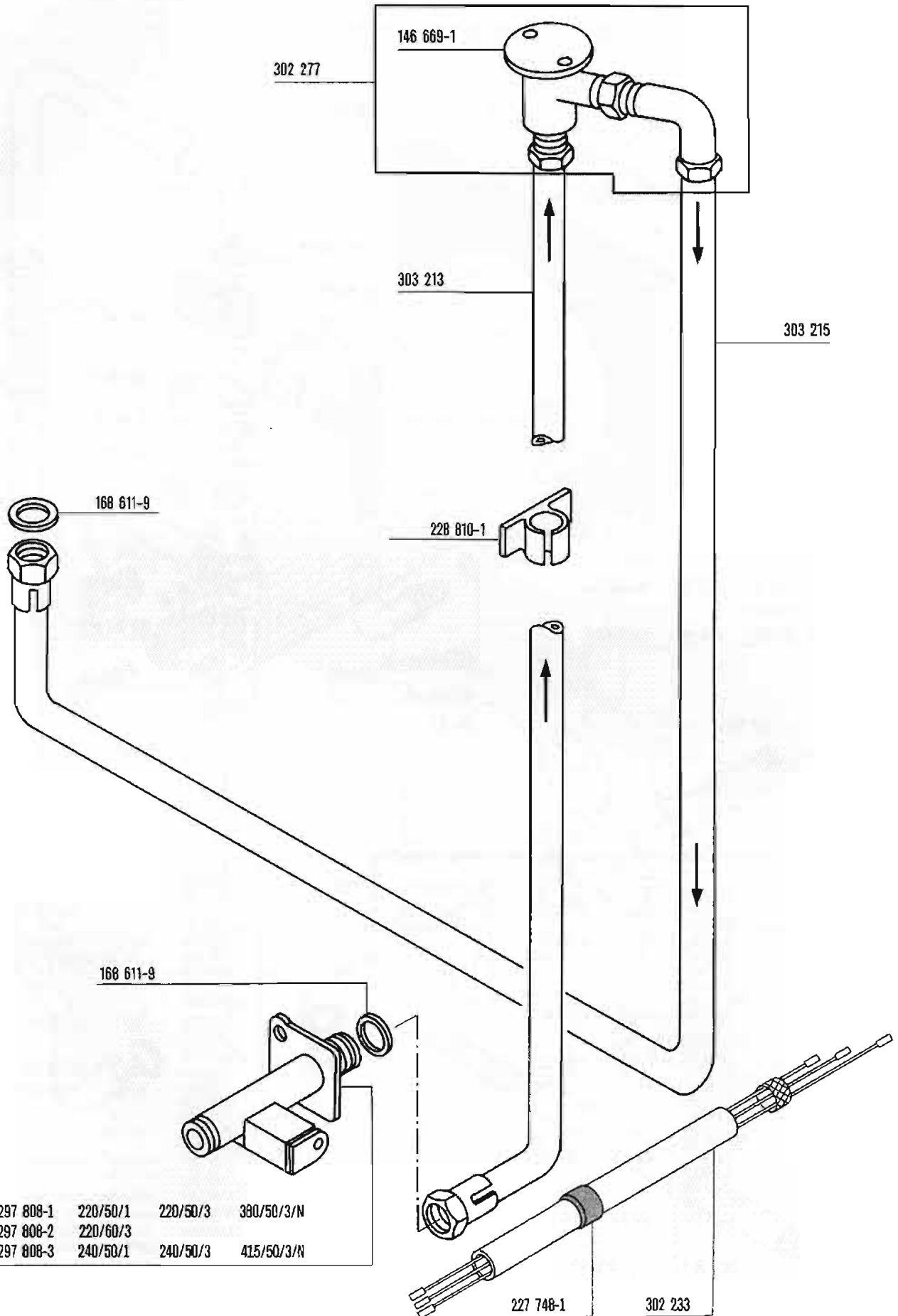

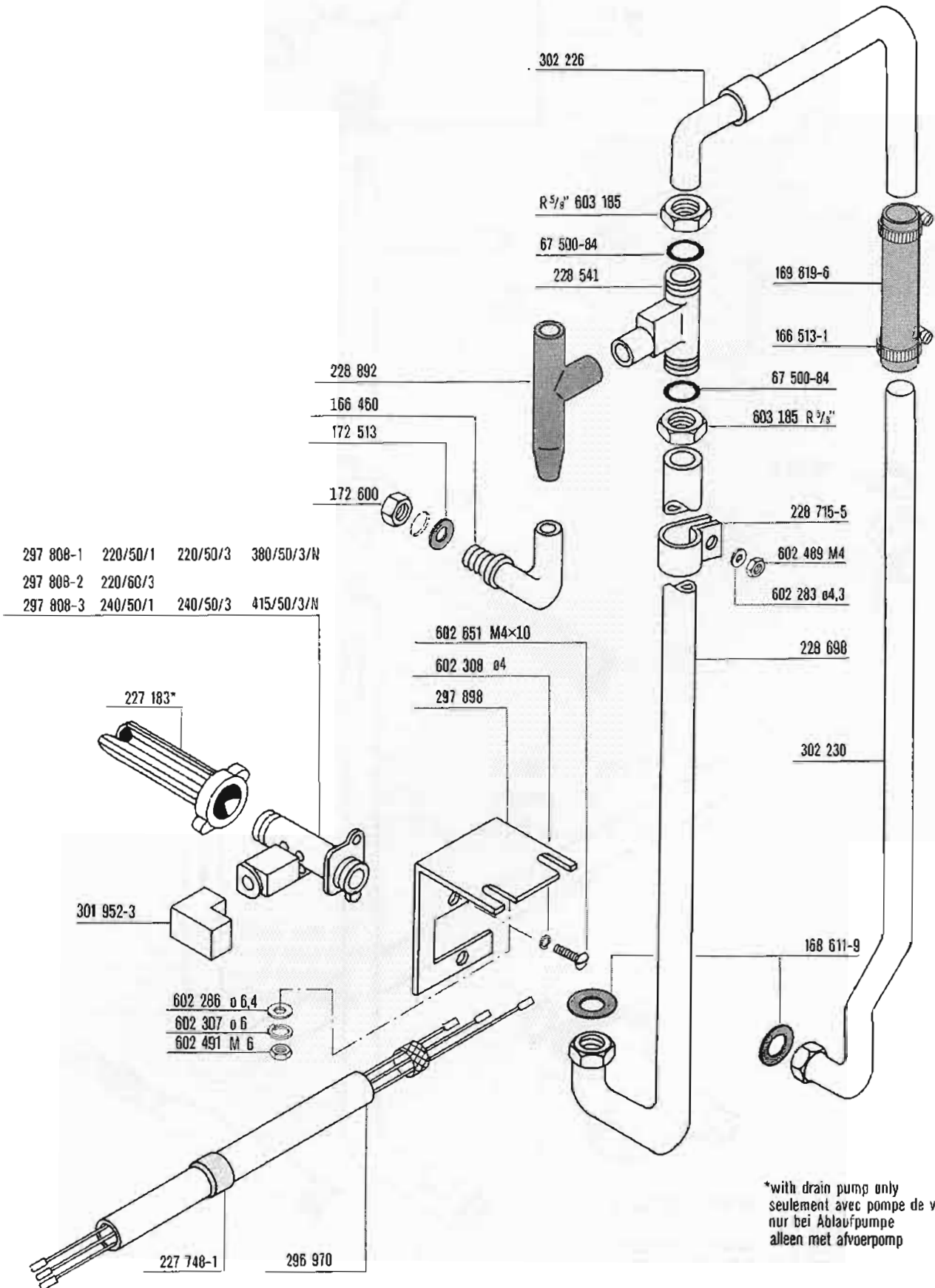

*with drain pump only
 seulement avec pompe de vidange
 nur bei Ablaufpumpe
 alleen met afvoerpomp

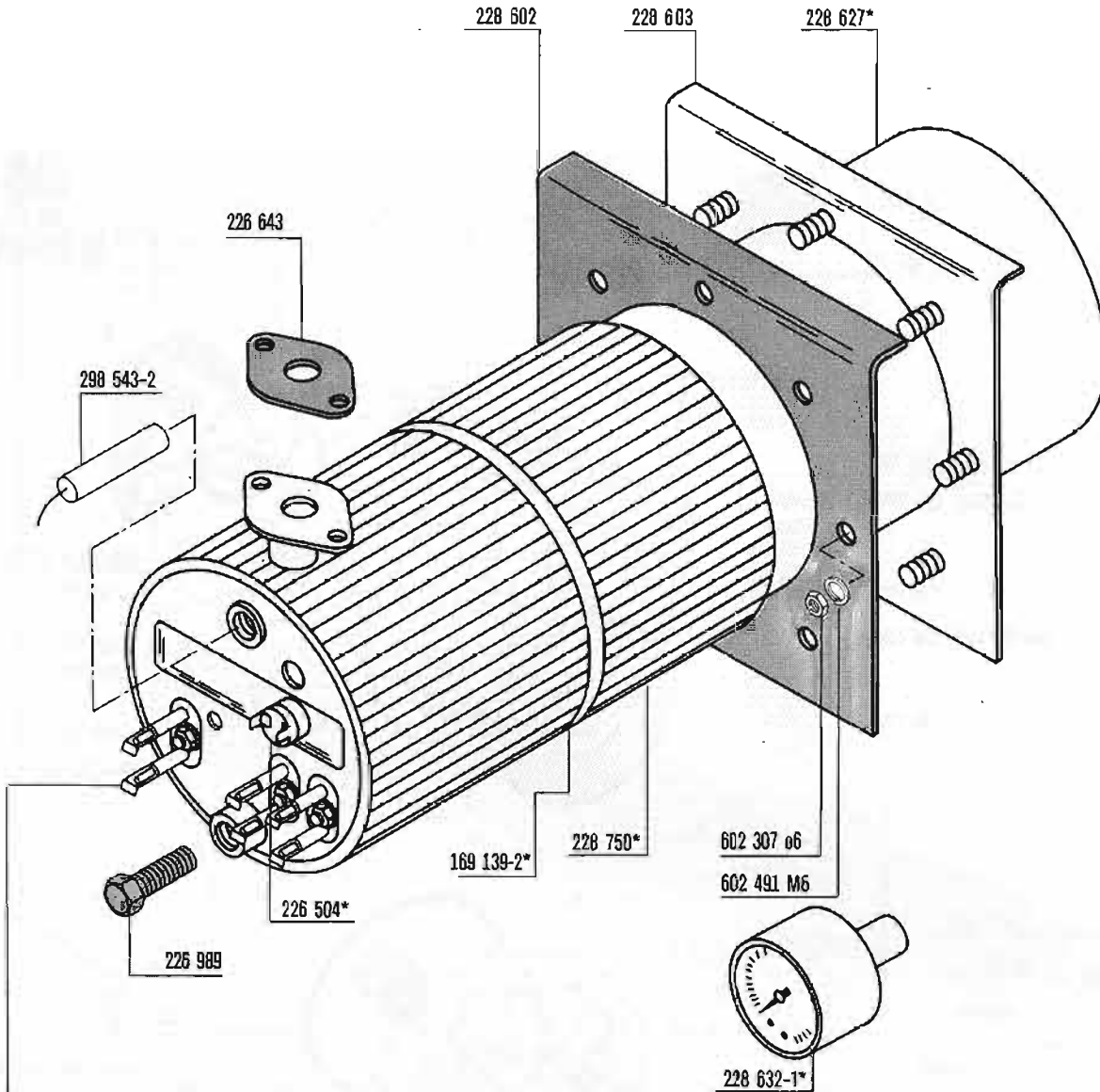

228 579-1*	2,5 kW	380/50/3 380/50/3/N
228 579-2*	2,5 kW	415/50/3 415/50/3/N
228 579-3*	2,5 kW	440/60/3
227 953-1*	2 kW	220/50/3 220/60/3 380/50/3 380/50/3/N
227 953-2*	2 kW	240/50/3 415/50/3 415/50/3/N
227 953-3*	2 kW	440/60/3
165 099-1*	1,5 kW	220/50/1 220/50/3 220/60/3 380/50/3 380/50/3/N
165 099-2*	1,5 kW	240/50/1 240/50/3 415/50/3 415/50/3/N
165 099-3*	1,5 kW	440/60/3

assembly incl.*	228 626-3	7,5 kW	380/50/3 380/50/3/N
ensemble compr.*	228 626-4	7,5 kW	415/50/3 415/50/3/N
komplett inkl.*	228 626-6	7,5 kW	440/60/3 220/50/3 220/60/3 380/50/3 380/50/3/N
	228 626-7	6 kW	220/50/3 220/60/3 380/50/3 380/50/3/N
	228 626-8	6 kW	240/50/3 415/50/3 415/50/3/N
	228 626-9	6 kW	440/60/3
	228 826-1	4,5 kW	220/50/1 220/50/3 220/60/3 380/50/3 380/50/3/N
	228 626-2	4,5 kW	240/50/1 240/50/3 415/50/3 415/50/3/N
	228 626-5	4,5 kW	440/60/3

172 981-1	220-380/50/3-N
172 981-2	240-415/50/3-N
172 981-6	220/60/3
172 981-5	440/60/3

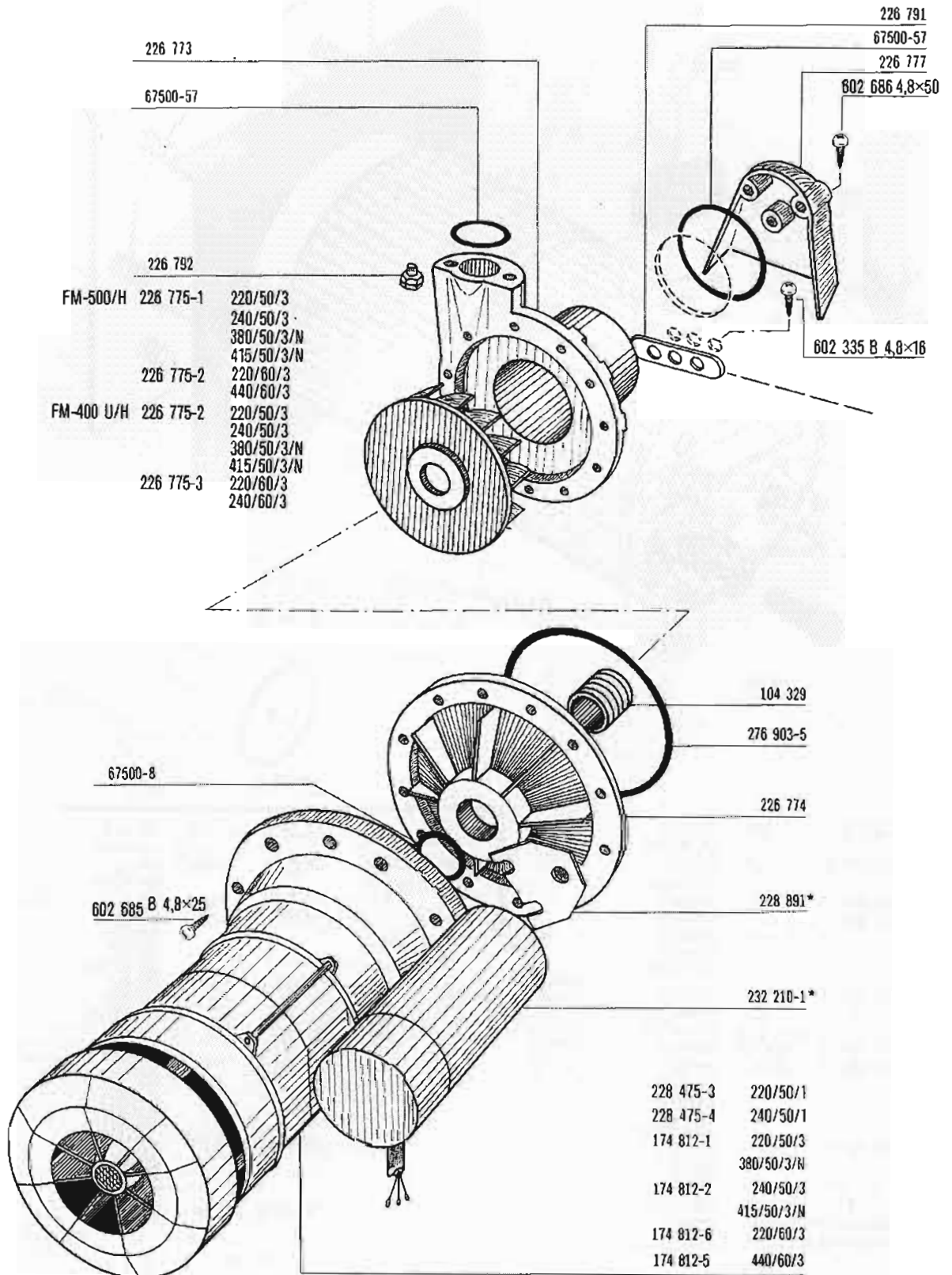

*only / seulement / nur / alleen 220-240/50/1

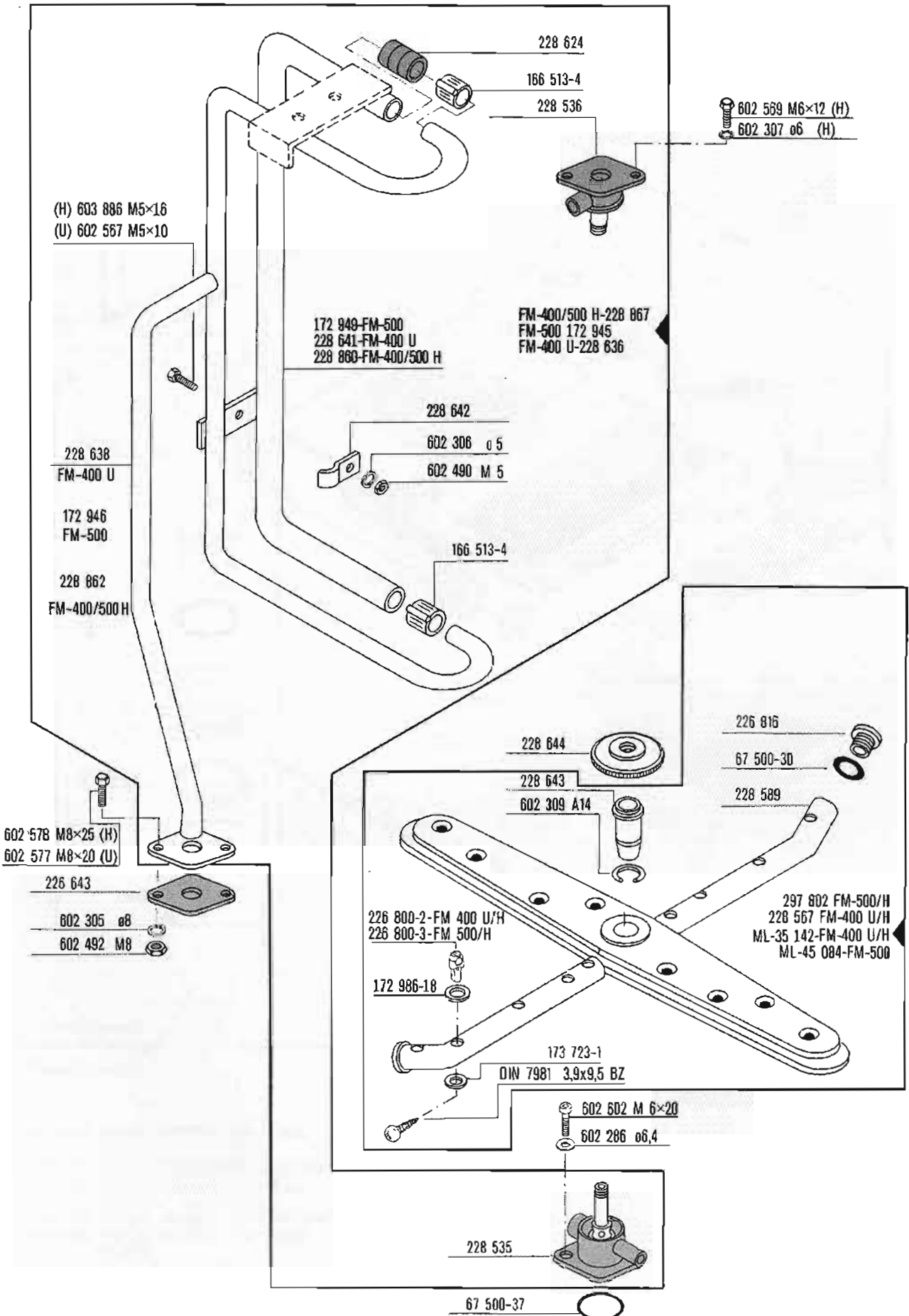

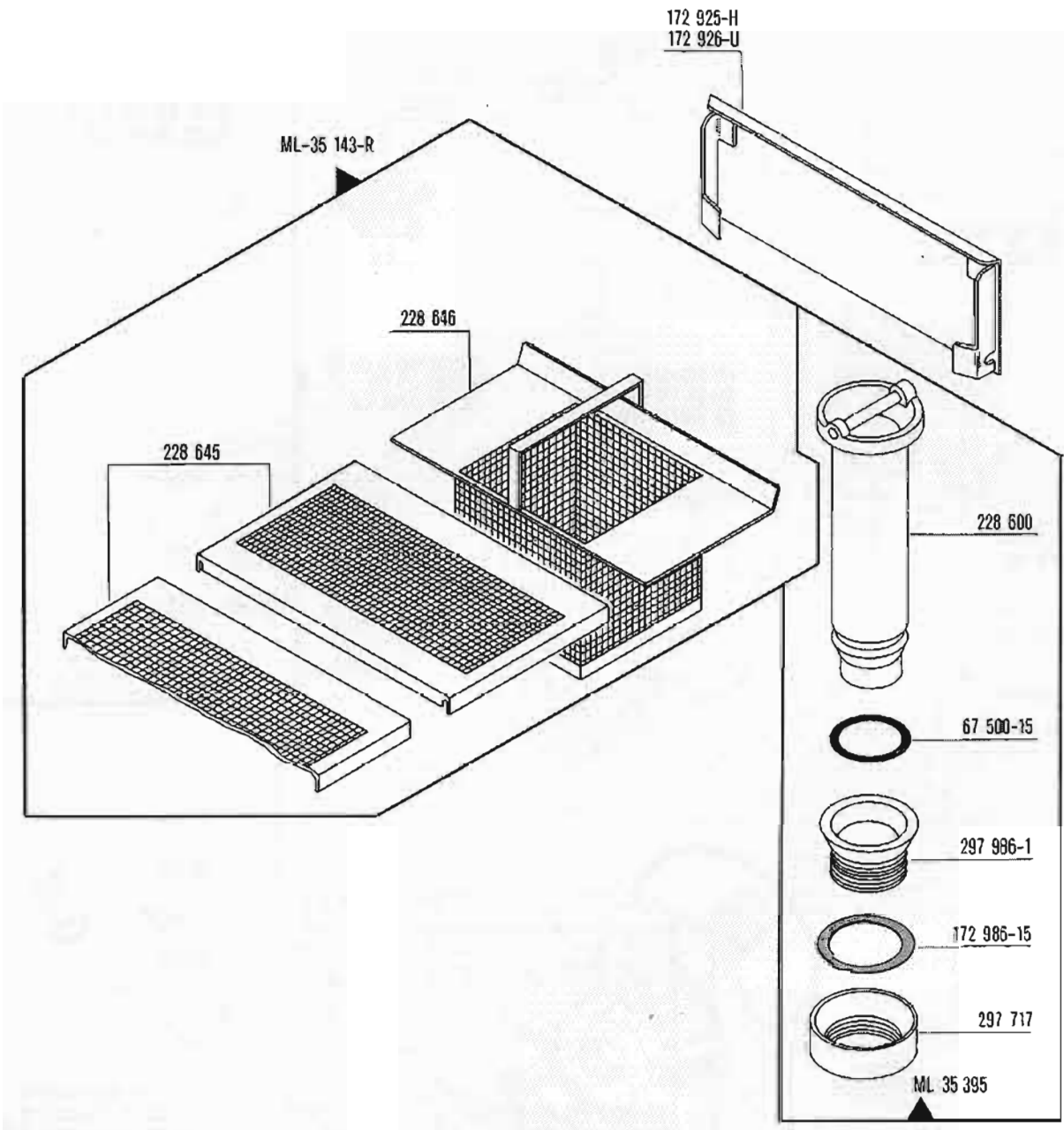

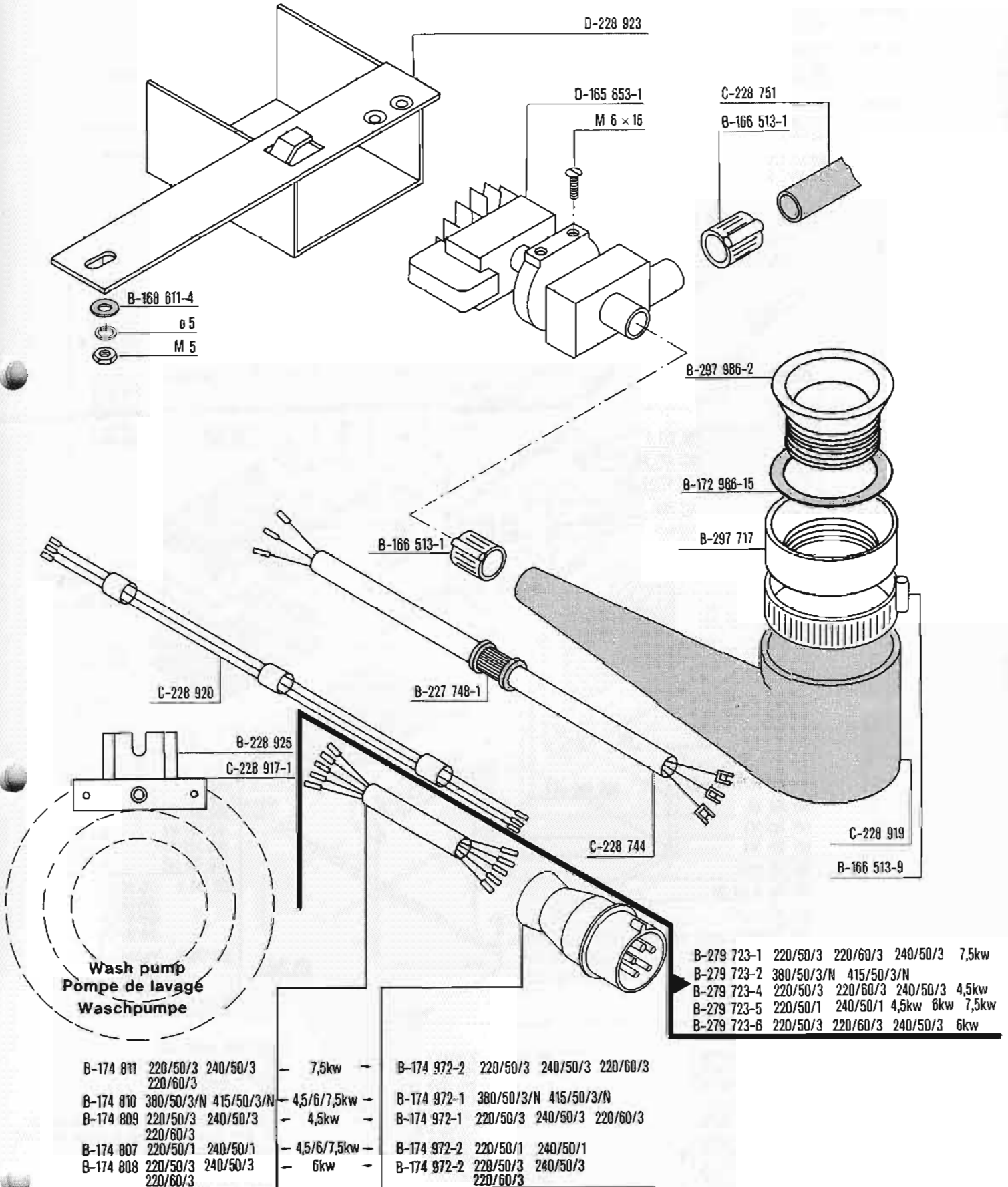

- 296 975 220/50/1
240/50/1
- 296 974 220/50/3
240/50/3
220/60/3
- 296 972 380/50/3
415/50/3
440/60/3
- 296 973 380/50/3/N
415/50/3/N

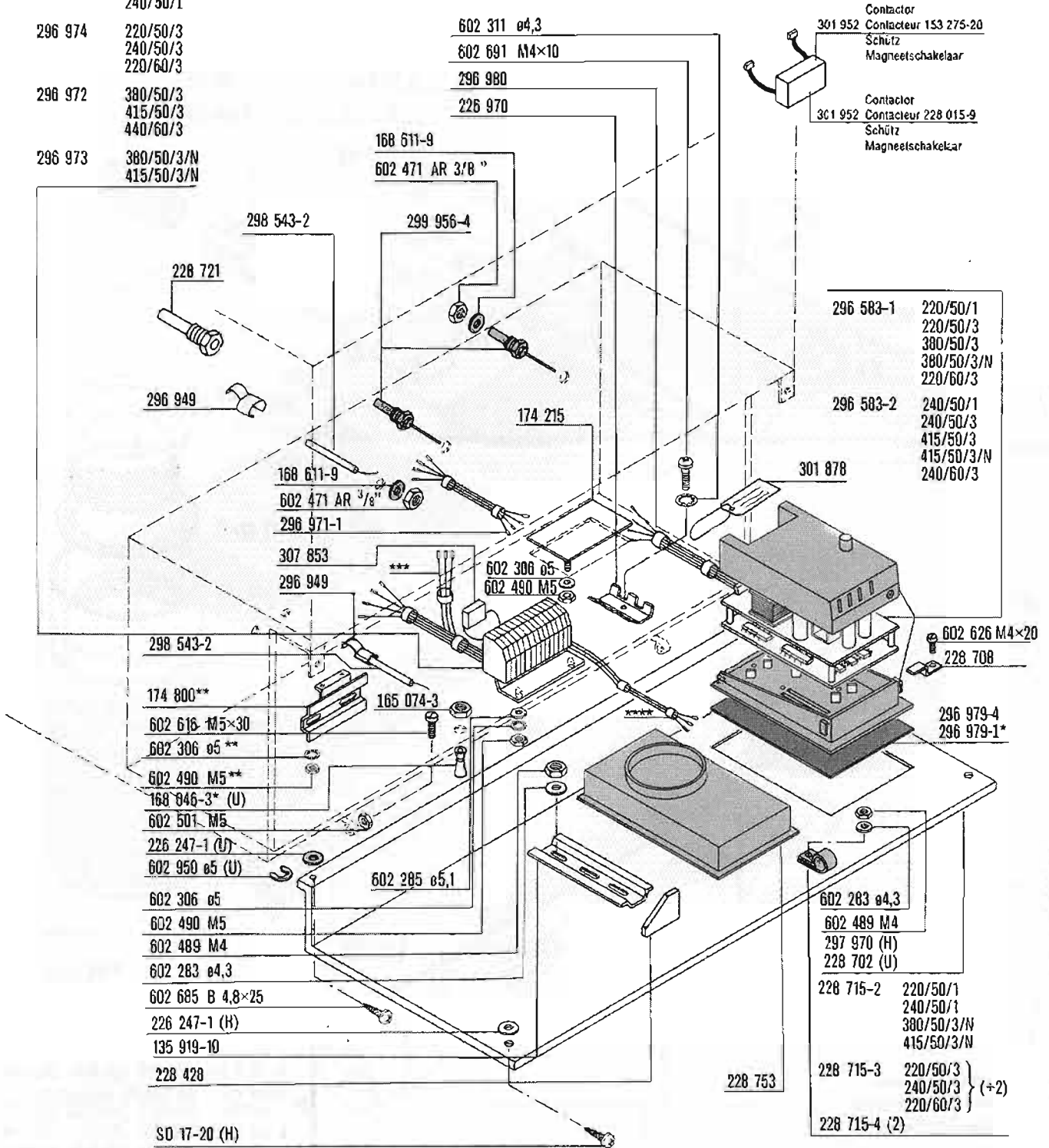

- *** 296 984 220/50/3
240/50/3
220/60/3
- 296 985 220/50/1
240/50/1
- 296 982 380/50/3
380/50/3/N
415/50/3
415/50/3/N
440/60/3

- **** 296 976 220/50/3
240/50/3
380/50/3
380/50/3
415/50/3
380/50/3/N
415/50/3/N
220/60/3
440/60/3
- 296 977 220/50/1
240/50/1

* with drain pump only
slt. avec pompe de vidange
nur mit Ablaufpumpe
alleen met afvoerpomp

** with rinse pump or detergent dispenser only
slt. avec pompe de rinçage ou doseur détergent
nur bei Drucksteigerungspumpe
oder Waschmittel-Dosiergerät
alleen met spoelpomp of afwasmiddel
doseerapparaat

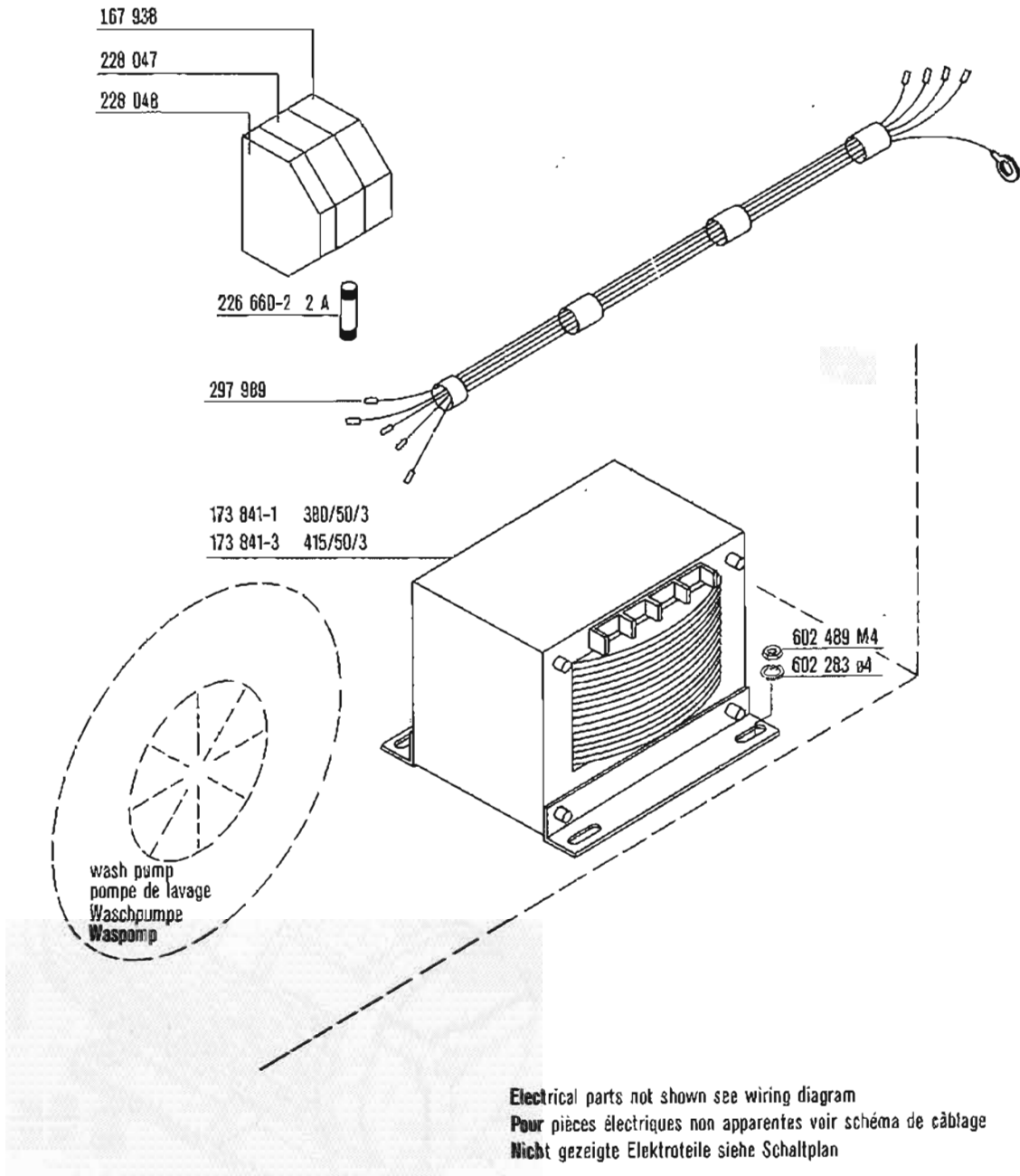

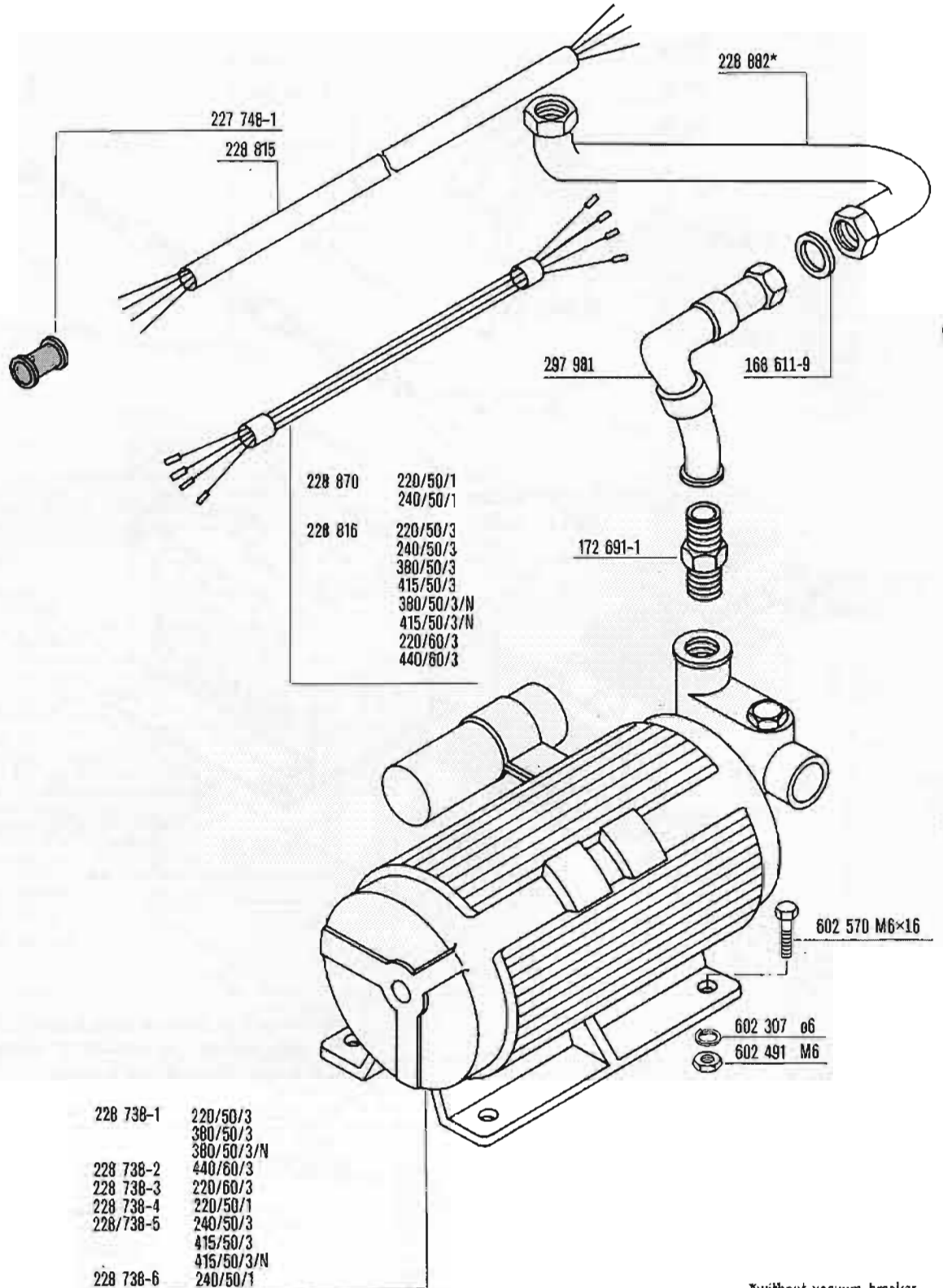

*without vacuum breaker
 sans brise vide
 ohne Rücksaugverhinderer
 Zonder vacuumbreker

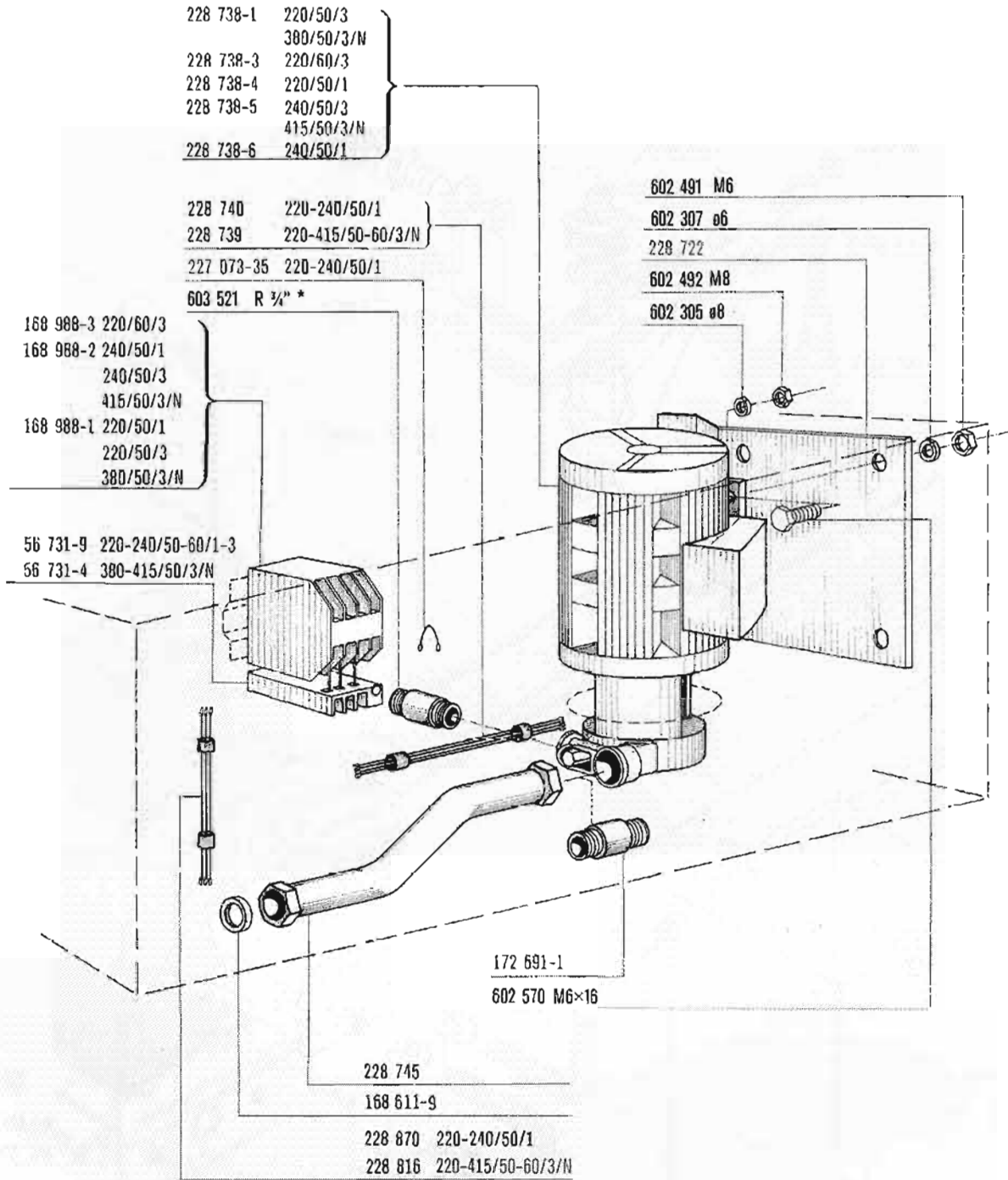

* with drain pump only
 slt. avec pompe de vidange
 nur bei Ablaufpumpe
 alleen met afvoerpomp

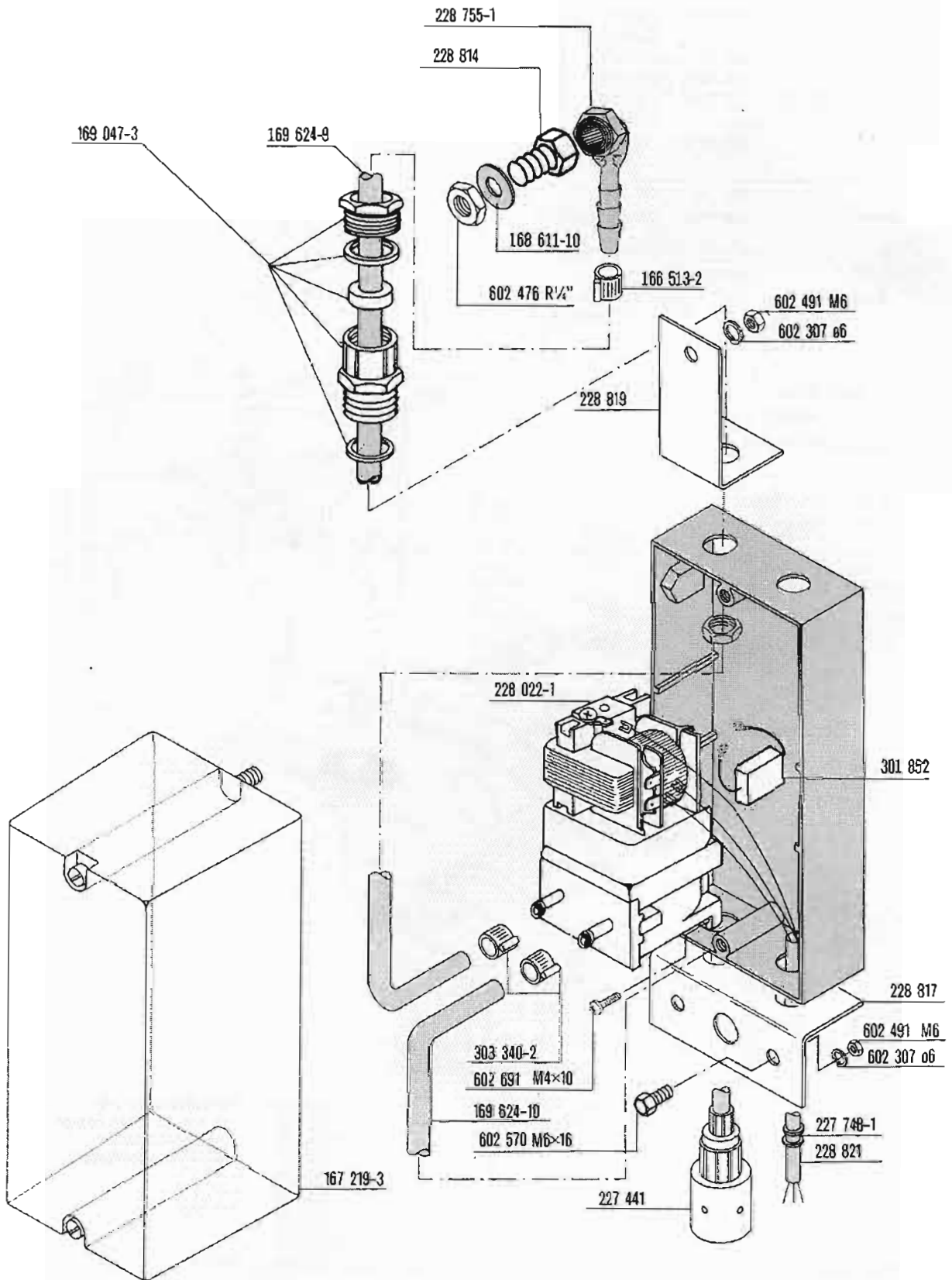

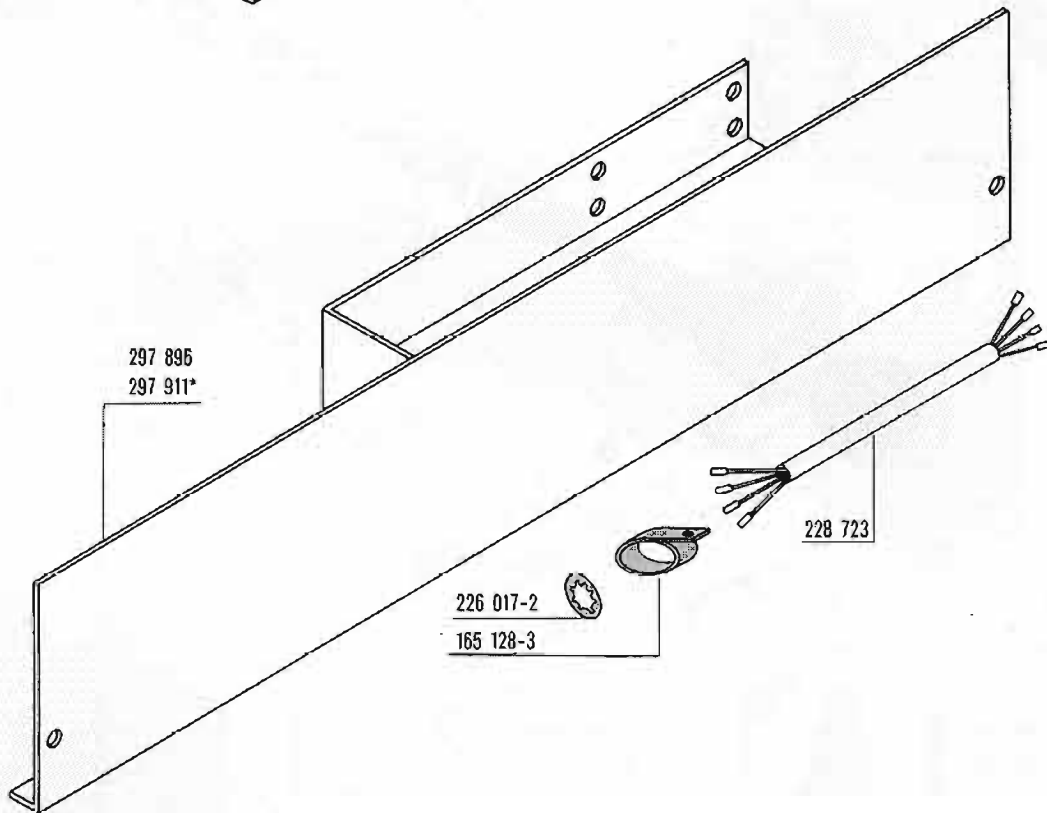
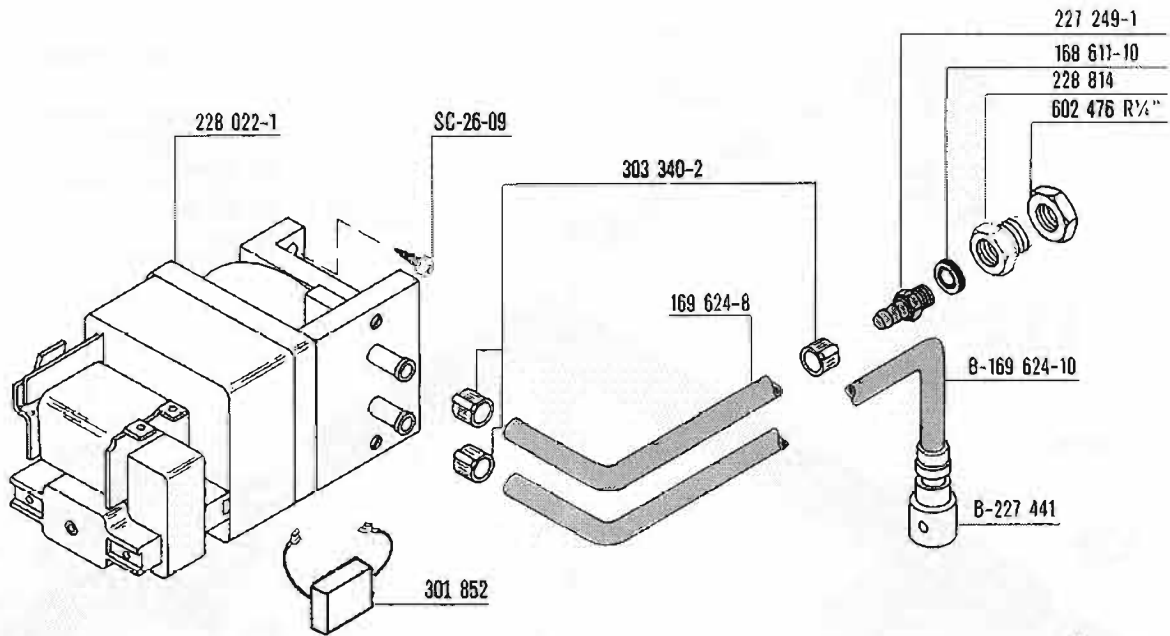

*900 mm machine height
 900 mm hauteur de la machine
 900 mm Maschinenhöhe
 900 mm hoogte

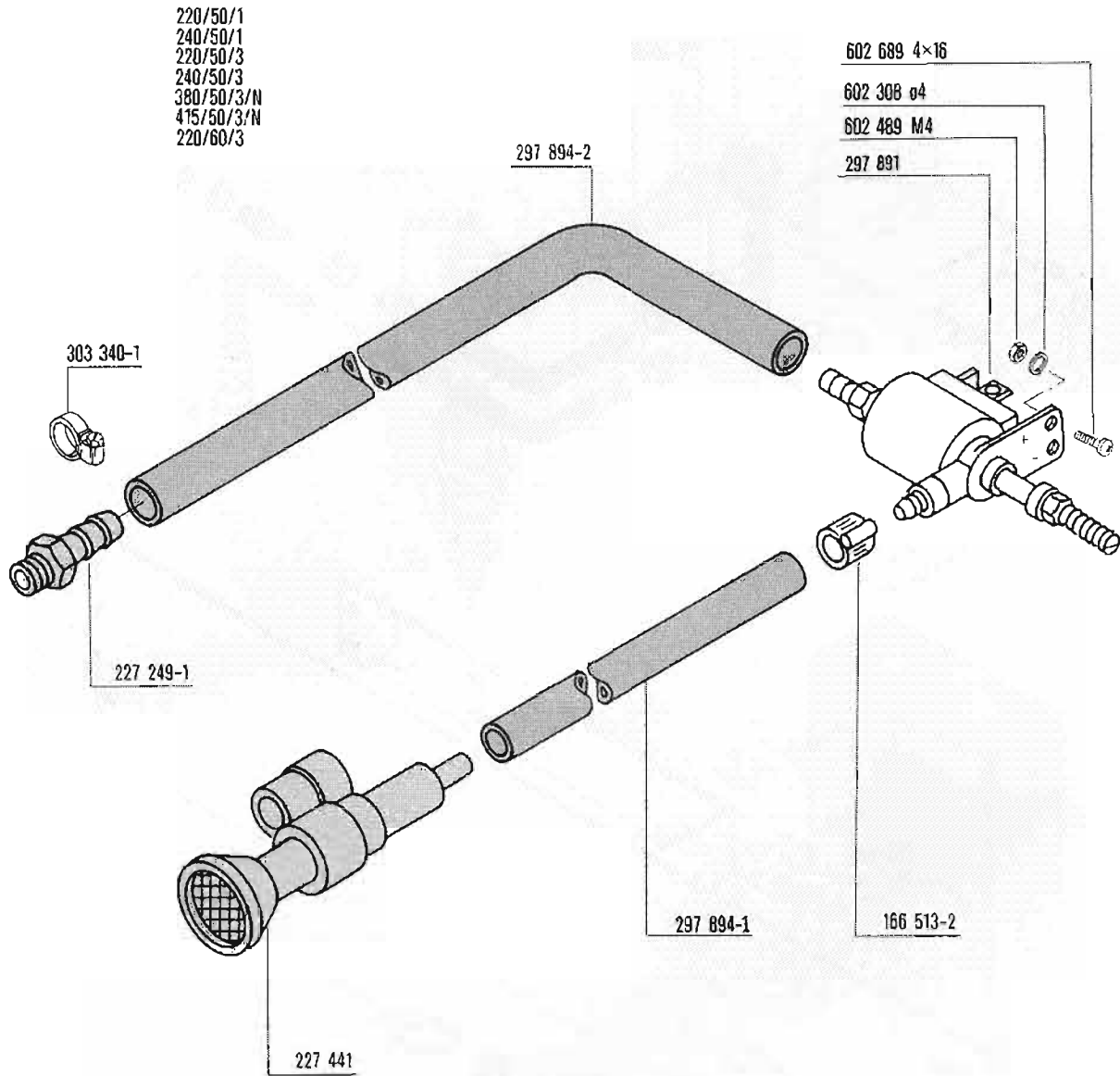

380/50/3 only
 415/50/3 sht.
 440/60/3 nur
 alleen

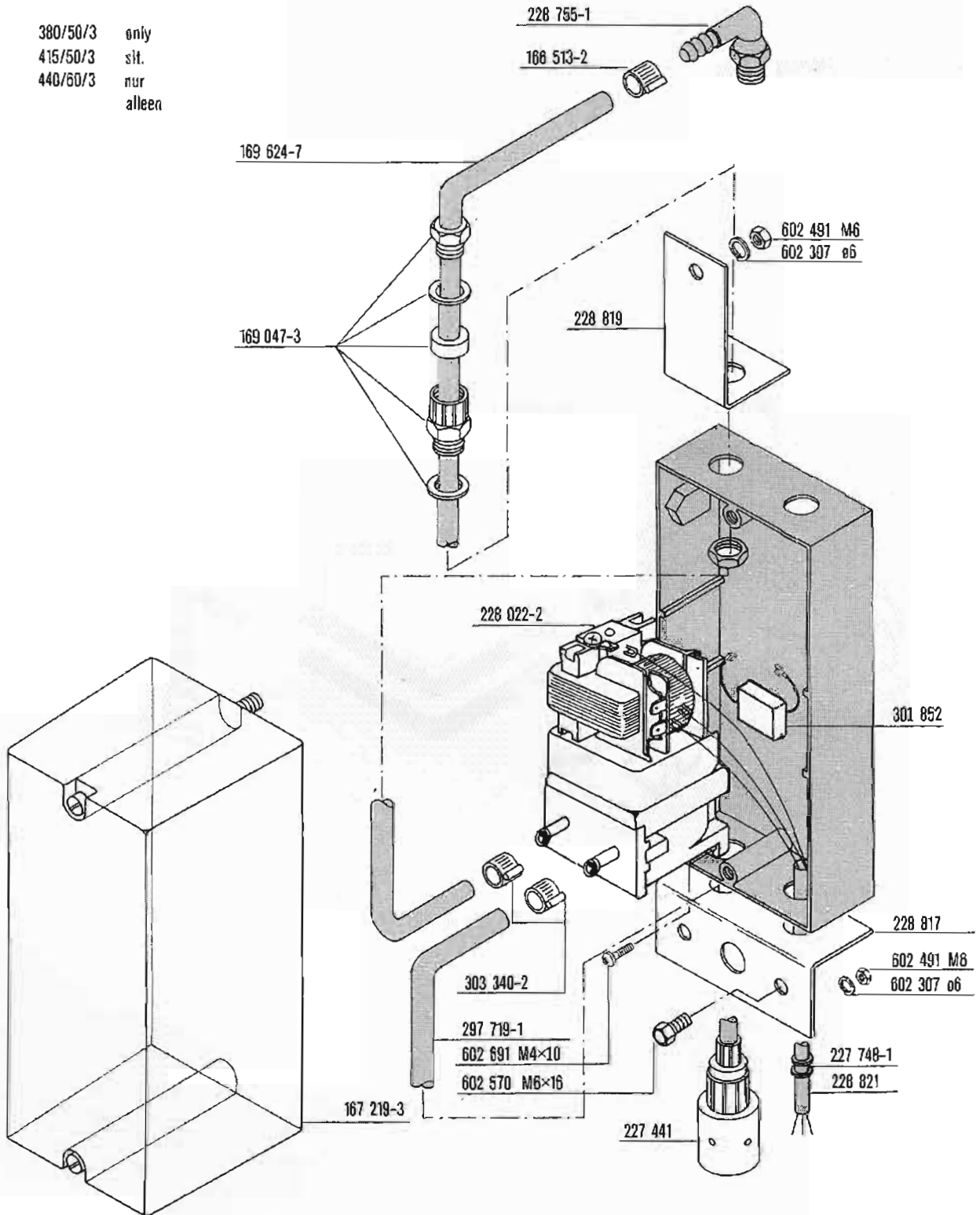

380/50/3 only
415/50/3 slt.
440/60/3 nur
alleen

